

CATALOGO TECNICO

Technical Catalogue



RACCORDI PORTAGOMMA E MICRORACCORDERIA BARBED AND MICRO FITTINGS



PLASTICA ALFA s.r.l



Azienda Certificata secondo le Norme
UNI EN ISO 9001 Certificato n° 303
UNI EN ISO 14001 Certificato n° 022

RACCORDI PORTAGOMMA - BARBED FITTINGS

Istruzioni per il montaggio - Assembly Instructions:

1. Tagliare il tubo
2. Inserire il raccordo nel tubo fino ad arrivare alla battuta

1. Cut the pipe
2. Insert the fitting into the pipe and push it to the beat



Materiali - Materials:

Art.: 12010 - 12011 - 14130 - 15120		ABS
Art.: 13010	Ø 16 - 20 Ø 16 - 90	ABS Polipropilene/polypropylene
Art.: 12014 - 12013 - 12015 - 12016 - 12040 - 12041 - 13020 - 14010 - 14020 - 14030 - 15010 - 16055 - 16053		Polipropilene/polypropylene
Art.: 12020		A - Polipropilene/polypropylene B - Poliammide - polyamide
Art.: 12030		A - ABS B - Poliammide - polyamide
Gommino termoplastica/thermoplastic rubber		Gomma termoplastica thermoplastic rubber

Derivazione con manicotto (a corpo unico)

Art. 12010

Offtake for PE pipes

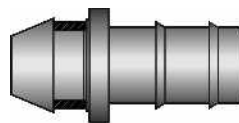
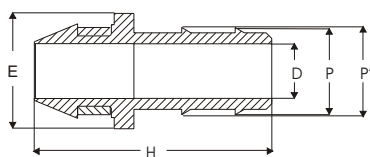

\emptyset	H	P	P'	D	E
16	45	15.5	16	10	22
20	48	19	20	12	22

Derivazione a corpo unico per tubo PVC

Art. 12011

Offtake for PVC pipes

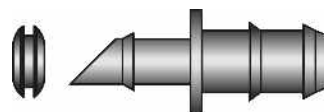
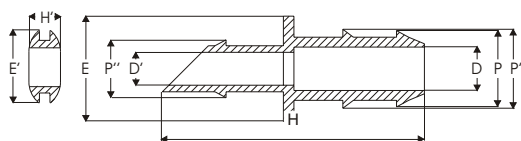

\emptyset	H	H'	P	P'	P''	D	D'	E	E'
16	47.5	8.5	15	16	11	10	6	19	18.5
20	47.5	8.5	18	20	11	12	6	19	18.5

Derivazione per tubo PE

Art. 12014

Offtake for PE pipes

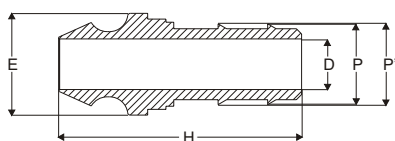

\emptyset	H	P	P'	D	E
16	47	16	15	10	19
20					

Tappo con gommino

Art. 12013

Plug with rubber

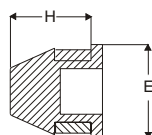

H

E

18

18

Derivazione con gommino (per tubo PE)

Art. 12015

Offtake with rubber for PE pipes

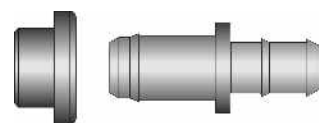
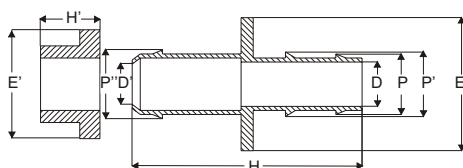

Ø

H

H'

P

P'

P''

D

D'

E

E'

16
20

56
59

15
15

15
19

16
20

17
18

10
12

12
12

23
23

27
27

Derivazione con gommino (per tubo PVC)

Art. 12016

Offtake with rubber for PVC pipes

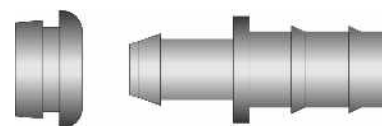
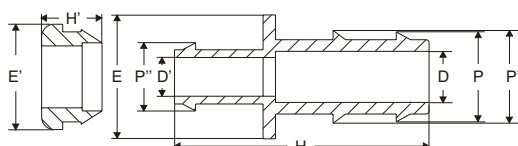

Ø

H

H'

P

P'

P''

D

D'

E

E'

16
20

49.5
47

14
14

15
19

16
20

14.5
15

10
14

9.5
10

22
21

24.5
24.5

Staffetta per derivare (da tubo in PE)

Art. 12020

Connecting saddle for PE pipes

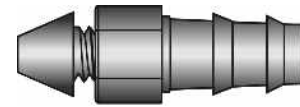
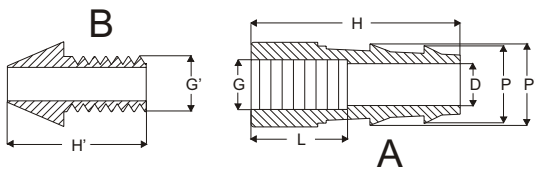

\emptyset	H	H'	P	P'	D	G	G'	L
16	37	24.5	14.5	16	8	9	10	16

Doppia derivazione (tipo A/7)

Art. 12030

Double offtake type A/7

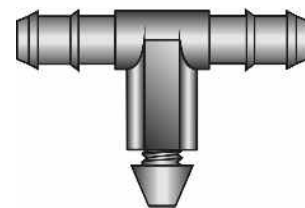
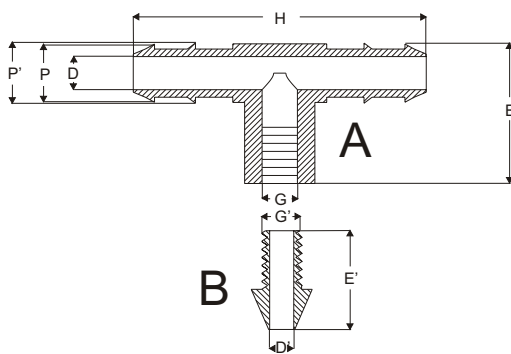

\emptyset	H	P	P'	D	D'	E	E'	G	G'
16	72	15	16	8	6	35	25	8	10

Derivazione filettata (a corpo unico per tubo PE)

Art. 12040

Threaded offtake for PE pipes

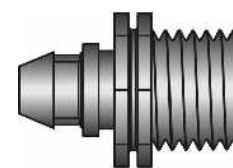
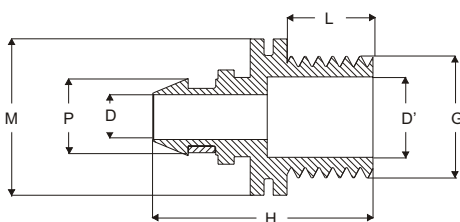

\emptyset	H	P	D	D'	M	G	L
1/2"	47.5	16.5	10	14	25	1/2"	17
3/4"	49	17	10	17.5	31	3/4"	19

Derivazione filettata (a corpo unico per tubo in PVC)

Art. 12041

Threaded offtake for PVC pipes

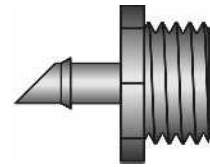
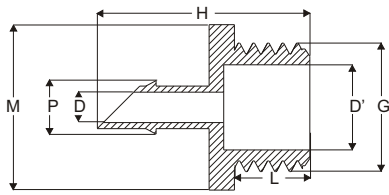

\emptyset	H	P	D	D'	M	G	L
3/4"	44	11	6	16.5	30	3/4"	15.5

Manicotto

Art. 13010

Coupling

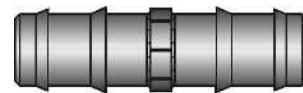
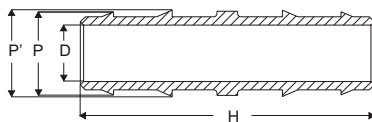

\emptyset	H	P	P'	D
16	52	15	16	10
20	53	19	20	13.5
25	89	24	25	17
32	88	31	32	23
36	88	35	36	26
40	87	38	40	28
50	131	47	50	38
63	166.5	59	63	49
75	186.5	68	75	59
90	190	82	90	68

Manicotto ridotto

Art. 13020

Reducing coupling

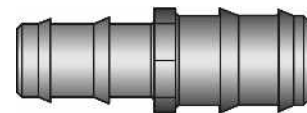
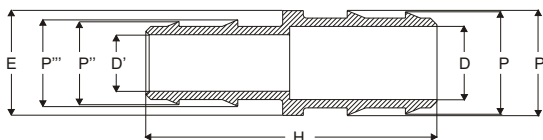

\emptyset	H	P	P'	P''	P'''	D	D'	E
20 X 16	52	19	20	15	16	14	10	21
25 X 16	82	24	25	15	16	17.5	10	23
25 X 20	88	24	25	19	20	17	12	23.5
32 X 25	88	31	32	24	25	22	17	29
40 X 32	86.5	38	40	31	32	28	22	36

T a 90° a portagomma

Art. 14010

90° barbed tee

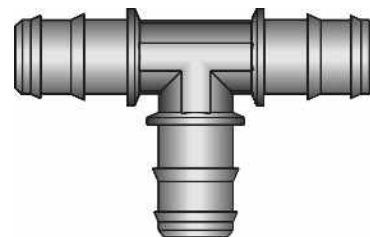
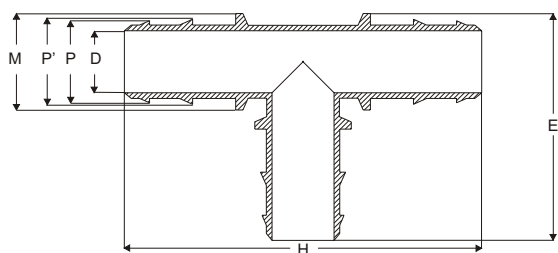

Ø	H	P	P'	D	M	E
16	64	14	16	10	13	39
20	98	19	20	14	23	60
25	104	24	25	19	28	66
32	120	30	32	24	31.5	75
36	124	35	36	27.5	35	78
40	135	38	40	29	38	85
50	145	47	50	39	49	97
63	252	59	63	49	57	155
75	270	68	75	58	67	168
90	289	84	90	68	80	186

T a 90° ridotto

Art. 14020

90° reducing tee

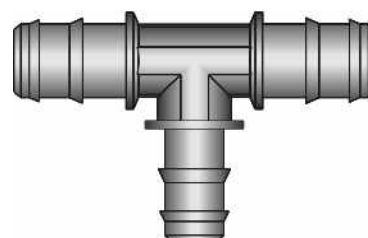
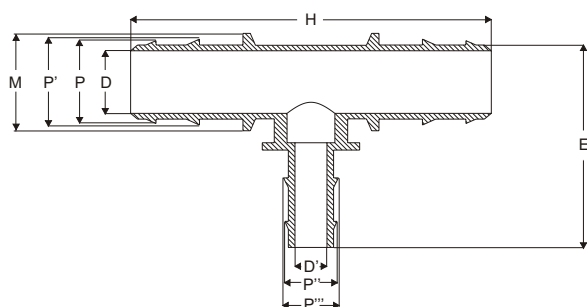

Ø	H	P	P'	P''	P'''	D	D'	M	E
16 x 20 x 16	71	15	16	19	20	10	14	16	54
20 x 16 x 20	99	19	20	15	16	14	10	23	54
20 x 25 x 20	98	19	20	24	25	14	18	23	58
25 x 16 x 25	104	24	25	15	16	18	10	28	58
25 x 20 x 25	104	24	25	19	20	18	14	28	63
25 x 32 x 25	105	24	25	31	32	18	23	28	68
32 x 16 x 32	120	31	32	15	16	23	10	32	66
32 x 20 x 32	120	31	32	19	20	23	14	32	69
32 x 25 x 32	120	31	32	24	25	23	18	32	69
32 x 40 x 32	120	31	32	39	40	24	30	31	77
40 x 32 x 40	136	39	40	31	32	30	23	38	81

T a 90° (con derivazione filettata maschio)

Art. 14030

90° male threaded tee

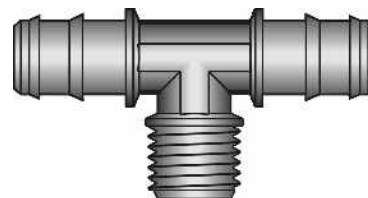
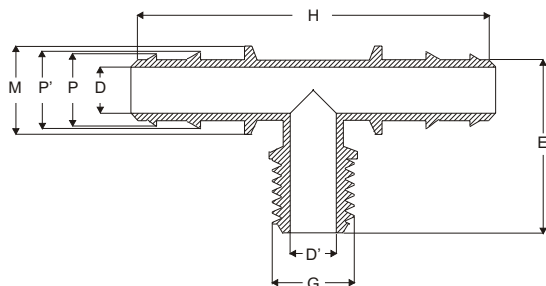

\varnothing	H	P	P'	D	D'	M	E	G
16 x 1/2" x 16	71	15	16	10	14	16	40	1/2"
16 x 3/4" x 16	71	15	16	10	17.5	16	41	3/4"
20 x 1/2" x 20	100	19	20	13	14	23	48	1/2"
20 x 3/4" x 20	100	19	20	13	17.5	23	55	3/4"
25 x 1/2" x 25	106	24	25	18	14	16	52	1/2"
25 x 3/4" x 25	104	24	25	18	17.5	28	53	3/4"
25 x 1" x 32	104	24	25	18	24	28	61	1"
32 x 1" x 32	120	31	32	24	24	31	59	1"
32 x 1 1/4 x 32	120	31	32	24	31	31	68	1 1/4"
36 x 1" x 36	124	35	36	28	24	35	61	1"
36 x 1 1/4 x 40	124	35	36	28	31	35	61	1 1/4"
40 x 1" x 40	137	39	40	31	24	38	65	1"
40 x 1 1/4 x 40	137	39	40	31	31	38	69	1 1/4"
40 x 1 1/2 x 40	137	39	40	31	39	38	75	1 1/2"
50 x 1 1/4 x 50								
50 x 1 1/2 x 50	145	49	50	39	39	47	75	1 1/2"

Portagomma filettato maschio

Art. 15010

Male threaded barbed fitting

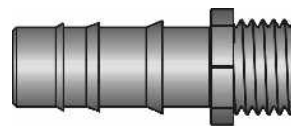
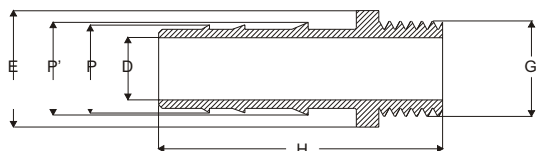

Ø	H	P	P'	D	E	G
16 x 1/2"	51	15	16	10	25	1/2"
16 x 3/4"	52	15	16	10	31	3/4"
20 x 1/2"	51	19	20	13	25	1/2"
20 x 3/4"	53	19	20	13	31	3/4"
25 x 1/2"	83	24	25	17	24	1/2"
25 x 3/4"	83	24	25	17	30	3/4"
25 x 1"	83	24	25	17	35	1"
32 x 1"	83	31	32	23	35	1"
36 x 1"						
40 x 1"	84	39	40	26	35	1"
40 x 1"1/4	84	39	40	26	43	1"1/4
40 x 1"1/2	84	39	40	26	51	1"1/2
50 x 1"1/2	84	49	50	37	51	1"1/2
63 x 2"	115	62	63	48	65	2"
75 x 2"						
75 x 2"1/2	131	74	75	60	80	2"1/2
90 x 2"	140	74	75	72	80	2"
90 x 3"	130	89	90	69	91	3"

Gomito a 90°

Art. 16055

90° elbow

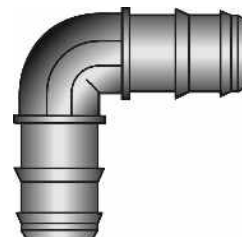
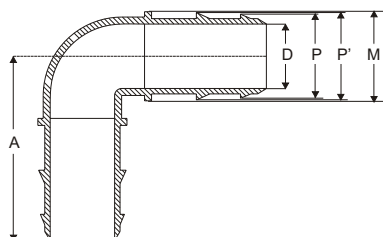

Ø	P	P'	D	M	A
16	15	16	10	22	39
20	19	20	14	23	49
25	24	25	18	27	52
32	31	32	24	31.5	60
36	35	36	28	35	62
40	39	40	31	38	67
50	49	50	39.5	49	72
63	62	63	49	57	127
75	74	75	60	67	138
90	89	90	69	79	145

Gomito a 90° Filettato maschio

Art. 16053

90° male threaded elbow

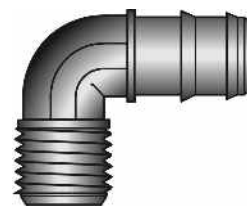
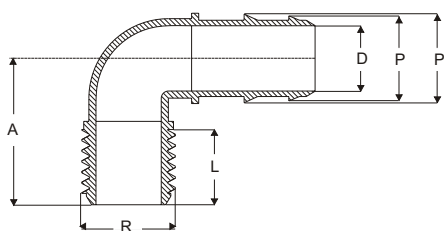

Ø	P	P'	D	A	R	L
16 x 1/2"	15	16	10	33	1/2"	16
16 x 3/4"	15	16	10	32	3/4"	17
20 x 1/2"	19	20	14	38	1/2"	21
20 x 3/4"	19	20	14	37	3/4"	21.5
25 x 1/2"						
25 x 3/4"	24	25	18	41	3/4"	20
25 x 1"	24	25	18	50	1"	21
32 x 1"	31	32	23	44	1"	19
32 x 1 1/4"	31	32	23	53	1 1/4"	21
36 x 1"	35	36	28	46	1"	21
36 x 1 1/4"	35	36	28	45	1 1/4"	21
40 x 1"	39	40	30	57	1"	21
40 x 1 1/4"	39	40	30	48	1 1/4"	21
50 x 1 1/2"						

Raccordo a Y

Art. 14130

Y fitting

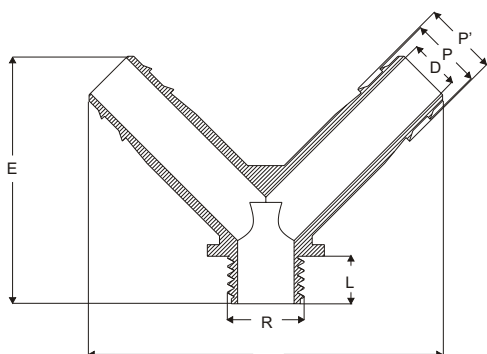

Ø	E	P	P'	D	R	L
3/4" X25X25	87	14	25	9	3/4"	86
1" X25X25	87	23	25	9	3/4"	92
1" X32X32	95	30	32	17	1"	92
1"1/4X32X32	87	30	25	23	3/4"	97

Giunto a portagomma con ghiera filettata

Art. 15120

Barbed fitting with nut connection

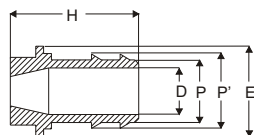
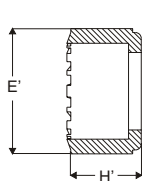

Ø	H	H'	P	P'	D	E	E'
3/4" X12	33	19	11	12	7	23	31
3/4" X16	33	19	15	16	10	23	31
3/4" X20	33	19	19	20	12	23	31

Micro raccorderia ed accessori - Micro fittings and accessories

Istruzioni per il montaggio - Assembly Instructions:

1. Inserire il tubo ed il microraccordo nella pinza (pinza per l'inserimento delle olivette)
2. Eseguire un foro nella tubazione principale con l'apposita fustella
3. Connettere l'innesto alla tubazione principale

1. Insert the pipe and the fitting into the pliers (pliers to insert olivetta)
2. Punch the main line using the proper hollow punch
3. Connect the joint to the main line



Materiali - Materials:

Art.: 13030 - 13031 - 13032 - 13033 -
13034 - 13035 - 16032

Resina acetica/Acetal resin

Art.: 16030 - 13050

Polipropilene/Polypropylene

Olivetta di derivazione per tubicino in PE o PVC plastificato

Art. 13030

Olivetta with offtake for PE or plasticized PVC pipe

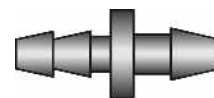
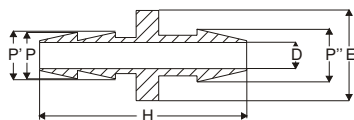

\emptyset	H	P	P'	P''	D	E
3.5 X 5	22	3	3.5	5	3	10
5 X 8	25	4.5	5	8	4	10

Olivetta filettata

Art. 13031

Threaded olivetta

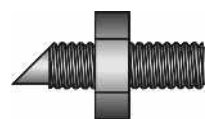
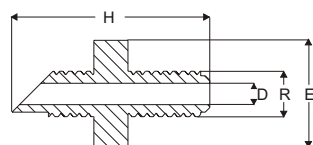

\emptyset	H	D	R	E
4	21	3	5	10

Olivetta smontabile

Art. 13032

Demontable olivetta

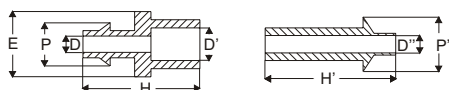

\emptyset	H	H'	P	P'	D	D'	D''	E
5	22	24	7	8	4	6	4	11.5

Manicotto per tubicino PE/PVC

Art. 13034

Coupling for PE or PVC pipes

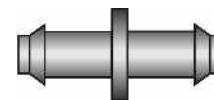
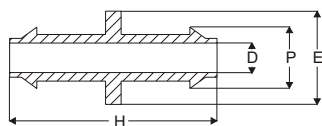

Ø	H	P	D	E
3.5	21	5	3	8
5	19	7	4	8

Olivetta a tee

Art. 13035

Tee olivetta

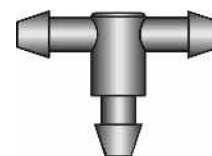
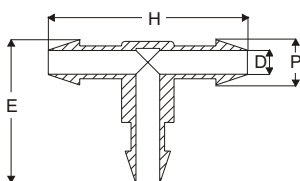

Ø	H	P	D	E
3.5	28	5.5	3	20
5	28	5.5	3	20

Tappetto ad innesto Art. 16030

Small plug

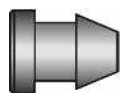
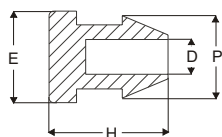

Ø	H	P	D	E
4				
6	12	6	3	10
8	13	5	4	10
10	10	10	5	11
16	33	16	8	12

Tappetto per olivetta

Smontabile

Art. 16032

Plug for demontable olivetta

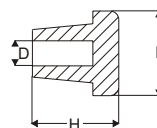

H	D	E
10	3	10

Gancio per sostegno

Tubo in PE

Art. 13050

Supporting hook for PE pipes

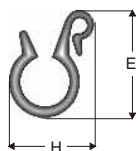

\emptyset	H	E
16	21	35
20	25	38
25	32	50
32		

Doppio anello

Art. 13060

Double ring

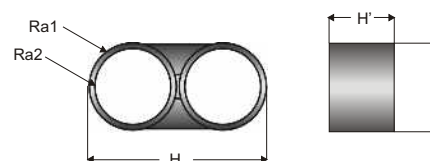

\emptyset	H	H'	Ra1	Ra2	E
16	42	13	11	8.5	23
20	52	14	13.5	11	27
25					

Astina con gancio

Art. 13080

Spike with hook

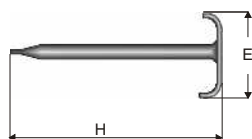

\emptyset	E	H
16-20	52	143

Anello di graffaggio

Art. 13070

Clinching ring

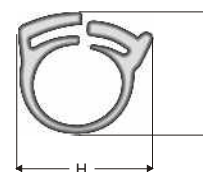

\emptyset	H	E
16	37	31
20	38	32

Sede legale e stabilimento: Zona Industriale C.da Balchino - P.O. Box 375
95041 - CALTAGIRONE (CT) - Italy
Tel. +39.0933.51973 PBX - FAX +39.0933.53049
E-mail: info@plasticalfa.com

WWW.PLASTICALFA.COM